



# UL Listed B-Vent Adaptability

Have you been in the field without the right brand of B-Vent? Metal-Fab understands and that's why we have come up with a solution to save you **time and money**.

## Metal-Fab B-Vent Connects Easily to Other Brands. You Don't Need Anything Else!

What should you do if the existing product make and model cannot be identified with certainty? Let Metal-Fab solve your problems, our B-Vent 3"-6" is **UL listed** to adapt to any competitor's B-Vent products. Metal-Fab's universal adaptability with other brands provides a competitive advantage in the field and you the installer only need one type of B-Vent.



Listed

### No Adapter Required?

Metal-Fab is the only B-Vent manufacturer with UL approval, to connect the male end into the female end of all competitive B-Vent brands, increasing product versatility. Did you know by simply connecting using three (3) quarter inch long screws to secure creates a **UL listed** connection?

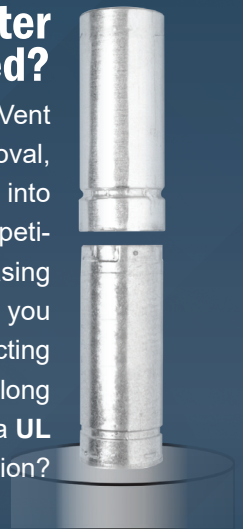

## Male Adapter

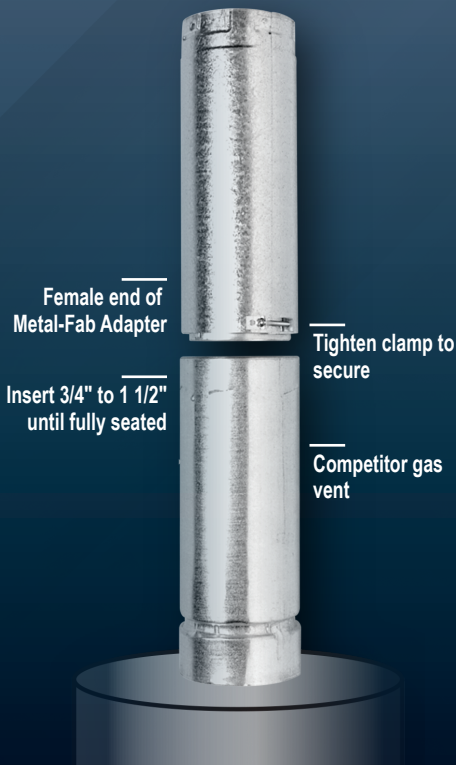

Female end of Metal-Fab Adapter

Insert 3/4" to 1 1/2" until fully seated

Tighten clamp to secure

Competitor gas vent

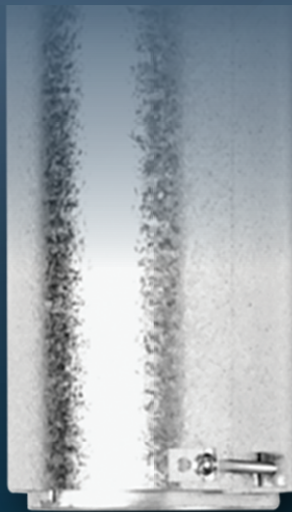

(Part # - M6A, M12A, M18A)

Mating two different brands does not have to cost you time and money. Metal-Fab B-Vent provides a solution in two easy steps. Simply insert the male end (outlet) of the competitive B-Vent brand into the female (inlet) of the Metal-Fab adapter, then tighten the adapter clamp.

### Female Adapter

(Part # - M6AF)

For those installing specialists and building code authorities who may prefer the



use of a female adapter in contrast to simply sheet metal screws. The female adapter is adjusted and the adapter clamp is tightened to competitive brand of B-Vent.



# B-Flex™ Adaptability



Listed

*Metal-Fab's double wall B-Flex™ can be used as a connector or segment of B-Vent into any competitor type B gas vent!*

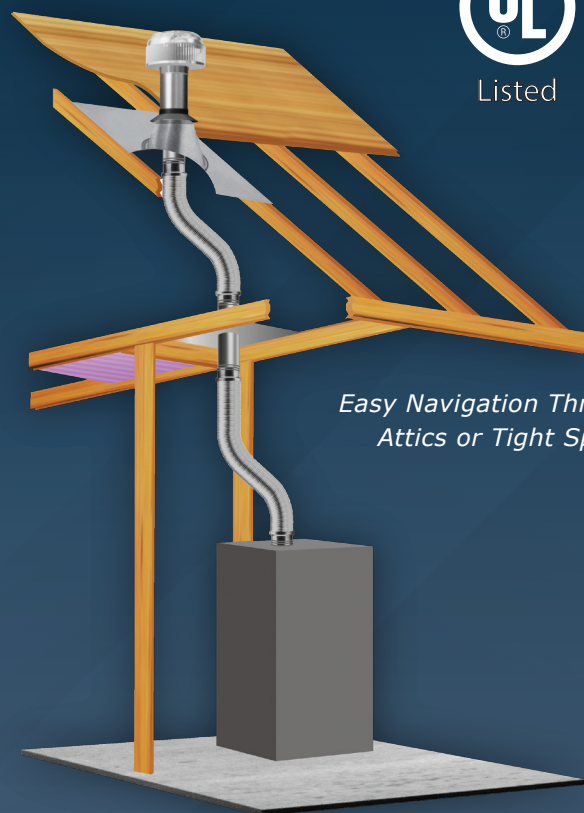
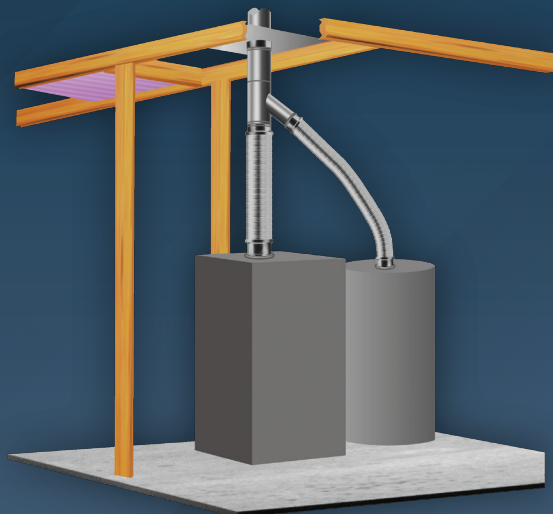

*Easy Navigation Through Attics or Tight Spaces*

## Applications

Use B-Flex™ anywhere B-Vent is required, except where pipe penetrates the structure walls, floors, ceilings or roof.

### Quick & Easy

*B-Flex™ eliminates special adapters, convoluted measurements, and assembly of rigid pipe lengths.*

### Convenience

*Ready to install right out of the box with factory assembled male and female positive twist-lock ends.*

### Cost Savings

*Saves time and labor, a universal solution to connecting appliances to rigid B-Vent.*

### Adaptability

*Can be used with other specifically identified competing brands of UL Listed round gas vent 3" through 6"*

Metal-Fab's approval includes connections at both male and female ends to the following B-Vent brands but is not limited to:

American Metal Products Co.  
Continental Industries, Inc.  
ECCO Manufacturing  
Hart & Cooley, Inc.  
M&G DuraVent, Inc.  
Mitchell Metal Products, Inc.  
Selkirk Corporation

(Amerivent)  
(AirJet)  
(Model E/R)  
(Hart & Cooley B-Vent)  
(Type B Gas Vent)  
(Mitch Vent)  
(Energy Vent)

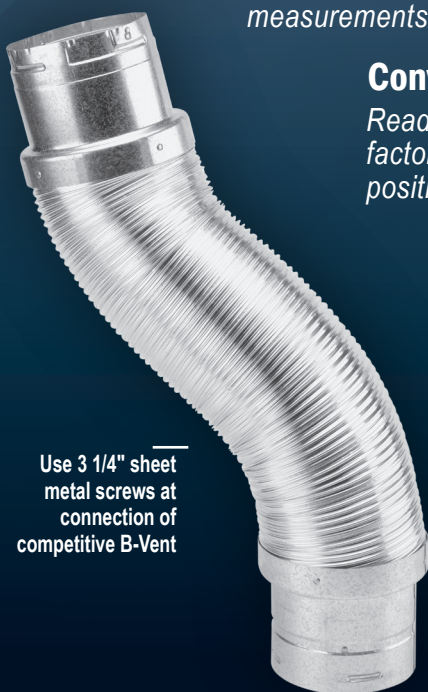

Use 3 1/4" sheet metal screws at connection of competitive B-Vent

100% ORDER FILL • ONE STOP VENT SHOPPING  
**Faster. Safer. Better.**